

PROVIDED:



TOOLS YOU MAY NEED:



NOTES:



OAKSTORE
HAND CRAFTED OAK FURNITURE

Oak Store Direct
Units 4-6
Station Road, Shipley
West Yorkshire, BD18 2JL

sales@oakstoredirect.com
www.oakstoredirect.com



OAKSTORE
HAND CRAFTED OAK FURNITURE

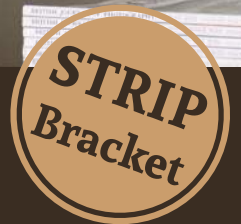

INSTALLATION GUIDE

ALCOVE SHELF FIXINGS



1

Use the spirit level to mark a level line at the required point of installation.

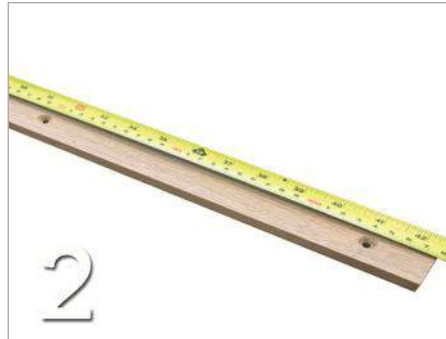

2

Use the tape measure and measure across all the hole centres



3

Transfer measurements across to the line on the wall for each centre point.

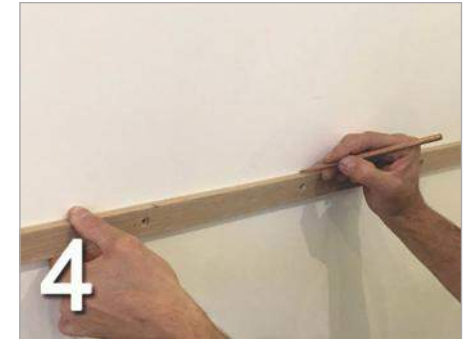

4

Now mark on the wall for each hole



5

Use the masonry drill with a 7mm masonry or SDS bit, and drill to a depth of 75mm, (you can use masking tape as a depth gauge)



6

Insert the 7mm rawl plugs provided and if required use the hammer to ensure the plugs are flush.



7

Fix the strip to the wall only hand tight and check for level. Make any adjustments by gently tapping on the strip.



8

Place the shelf on the strips and final check for level.

STRIP BRACKETS

This guide can be used to install alcove shelving and corner shelves with matching solid oak strip brackets.

Strip brackets are a very strong method of fixing shelving using a strip to fix underneath the shelf on two or three walls. Heavy weights can be applied using this fixing. Common for use with books, crockery, plants, LP's and other heavy items.

For more information visit our website or email us:
sales@oakstoredirect.com